



Republic of the Philippines
SOCIAL SECURITY SYSTEM
 East Avenue, Diliman, Quezon City

REQUEST FOR QUOTATION

2020-0025

February 4, 2020 PHILGEP'S REF. NO.: 16847786
 Date DATE POSTED : 2-7-20
 POSTED BY : ERIK A
 POSTPONED : 02-12-20

Sir / Madam:

Please furnish us with your quotation on or before **February 17, 2020 @ 5:00PM** for the following items:

No.	Quantity	PARTICULARS	Unit Cost	Total Cost
1	1 Lot	Supply of Labor & Materials for the installation of Two (2) units of platforms with railings for the Mufflers of Generator No. 1 & 2 located at SSS Powerhouse, East Avenue, Diliman, Quezon City <p style="text-align: center;"><i>(Please see attached Bill Of Quantities & Sample Lay-Outs)</i></p> GRAND TOTAL ABC = P 60,587.80 / Lot EFMD – Memo, PR # 1009-20 received by PPMD dated 2-4-2020 with Request # 2020-0072 [APP FY 2020, Original # 357 M/R F & E – Genset System]	P _____ /Lot P _____	

Delivery Terms: Thirty (30) Calendar Days upon receipt of approved Purchase Order / Job Order.

Payment Terms: Government Terms (Payment is upon delivery of items / services and submission of billing documents.)

Price validity : Three (3) Months.

- NOTE/S:**
- 1.) **For canvass with an ABC of P 100,000.00 and above**, the winning bidder is required to post a Performance Bond from receipt of Notice of Award equivalent to 5% Cash (Goods & Consulting Services) & 10% Cash (Infrastructure), Cashier's / Manager's Check, Bank Guarantee / Draft or 30% Surety Bond callable upon demand, of the contract price.
 - 2.) **Supplier is required to indicate his PhilGeps Registration Number on the canvass form.**
 - 3.) SSS shall withhold the applicable taxes from the amount payable in accordance with the BIR regulations.
 - 4.) Alternative offer is not allowed.
 - 5.) **Quantity is subject to change but not to exceed the approved P.O.**
 - 6.) **For clarification of details, please call Mr. Alesil Matias / EFMD at 920-6401 local 5537.**

This is to certify that my Company is updated in the payment of contributions and loans to SSS, and conformed with the above terms & conditions, and the data / quotation indicated are valid.

 Owner/Company Representative
 (Sign over Printed Name)

Reminder : Price quotation should be made with extra care taking into account the specification and unit of quantity to avoid errors. The offeror binds himself to this quotation.

Please indicate below your Business Name, Address and Telephone Number and Date Received.

Your Business SSS No. _____
 PhilGeps Registration No. _____
 T I N no. _____
 Date Received : _____

 (Business Name)

 (Address & Telephone No.)

 (E-mail Address)

Very Truly Yours,

HYDEE R. RAQUID

Department Manager III
 Procurement, Planning & Management Department
 Tel No. 920-6401 loc 5504-5507

Fax No. 435-9861

E-mail Address: bansilea@sss.gov.ph; pmd@sss.gov.ph

/ rcd /

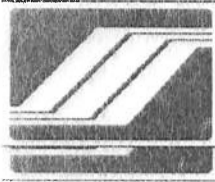

**SOCIAL SECURITY SYSTEM
ENGINEERING & FACILITIES MANAGEMENT DEPARTMENT**

Date : _____

PROJECT : Supply of Labor and Materials for the installation of Two (2) units of Platforms with railings, for the Mufflers for Generator No. 1&2.

LOCATION : SSS Powerhouse, East Ave., Diliman, Quezon City.

SUBJECT : BILL OF QUANTITIES

ITEM NO.	DESCRIPTION	QTY	UNIT	MATERIALS COST	
				UNIT COST	TOTAL COST
A	B	C	D	E	F
					C x E
I	MATERIALS				
1-A	75mm Ø G.I. Pipe, Schedule 40, 6M per length	3	lg.		
B	25mm Ø G.I. Pipe, Schedule 40, 6M per length	14	lg.		
C	Angle Bar (3/16" x 2" x 20ft.)	2	lg.		
D	Welding rod	3	Kg.		
E	Epoxy Primer	4	Ltr.		
F	Enamel paint	4	Ltr.		
G	Paint brush #1"	2	pcs.		
H	Paint brush #2"	2	pcs.		
2-A	Miscellaneous Items, i.e., Rental of Scaffolding (including hauling, to and from SSS Main Bldg.), equipment rental, etc.	1	lot		
Sub-total I					

II	LABOR	QTY	UNIT	LABOR COST	
				UNIT COST	TOTAL COST
C	Labor Cost = ____% x (Sub-total I)	1	lot		
Sub-total II					

III	Mark-up (Overhead profit, contingency, etc.) ____% (Sub-total I +Sub-total II)	1	lot		
Sub-total III					

IV	12% VAT = (12%) (Sub-total I + Sub-total II + Sub-total III)				
----	--	--	--	--	--

GRAND TOTAL = Sub-total I + Sub-total II + Sub-total III +Sub-total IV

Summary of Cost Breakdown

- 1 Material Cost -----
- 2 Labor Cost (____% x Item 1) -----
- 3 Mark-up (Overhead profit, contingency, etc.)
@ ____% x Item (1+2) -----
- 4 12% VAT [12% x Item (1+ 2 + 3)]-----

TOTAL ESTIMATED PROJECT COST: _____

PRINTED NAME OVER SIGNATURE
Authorized Company representative

Date submitted: _____

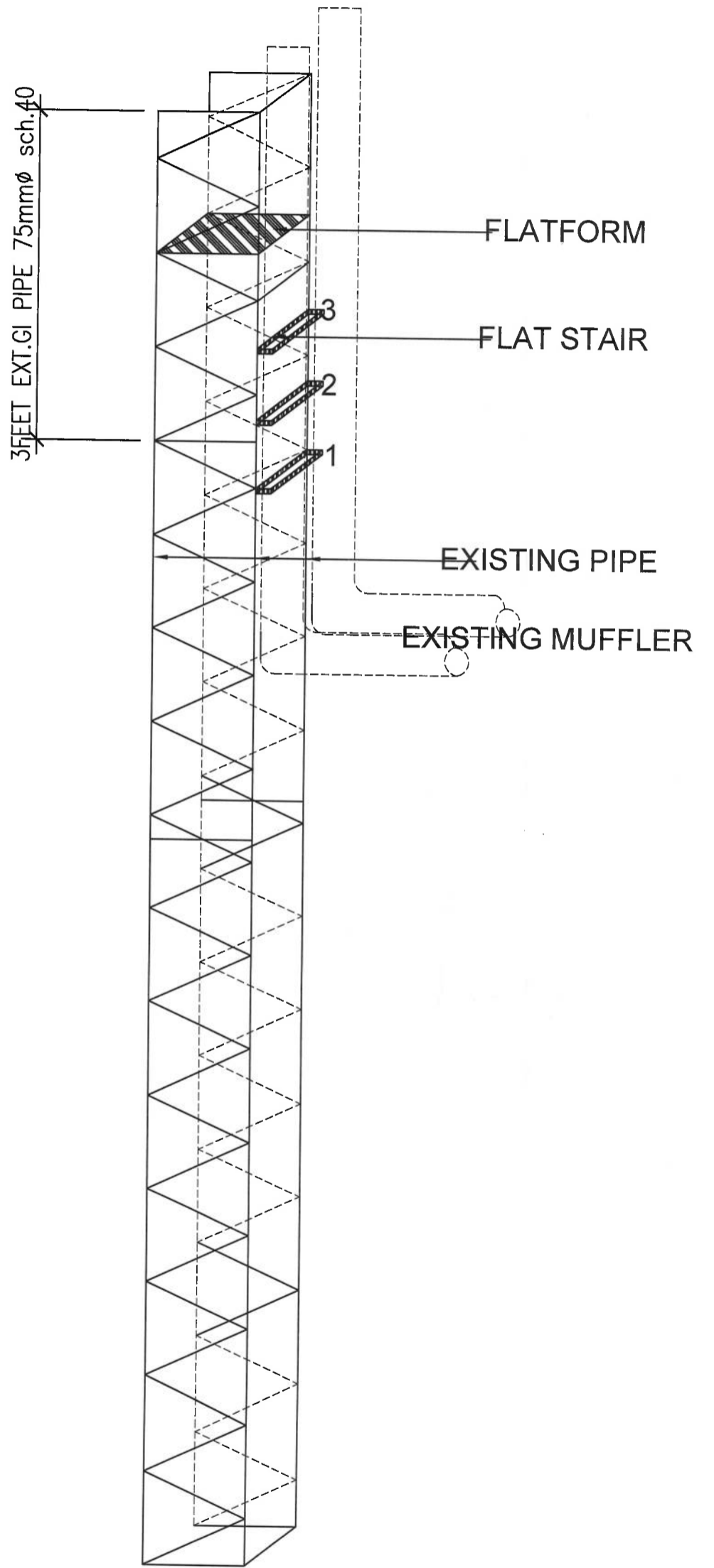
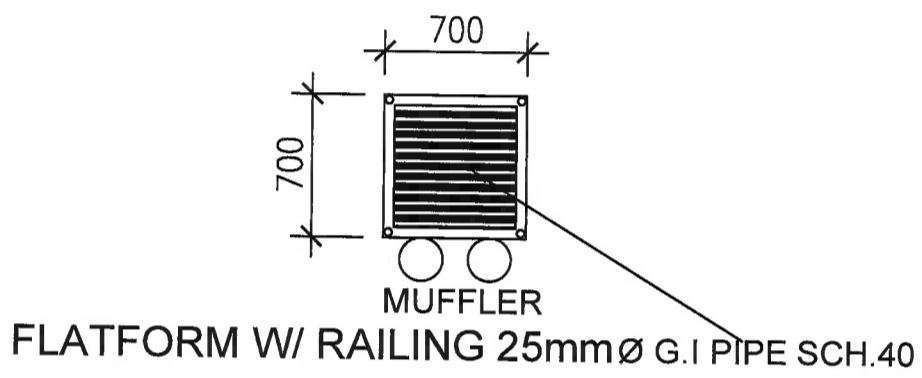

ISOMETRIC VIEW

SOCIAL SECURITY SYSTEM
RECEIVED
 06 FEB 2020
 AMY 2:53 PM
 PROCUREMENT



FRONT VIEW

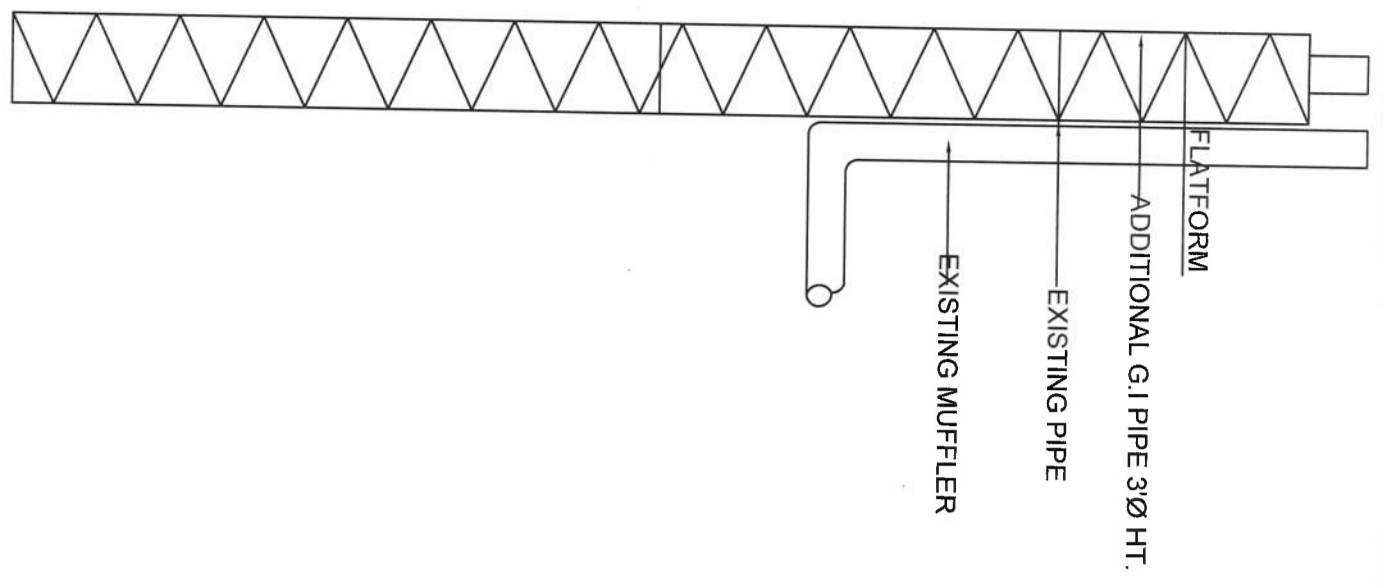

LEFTSIDE VIEW

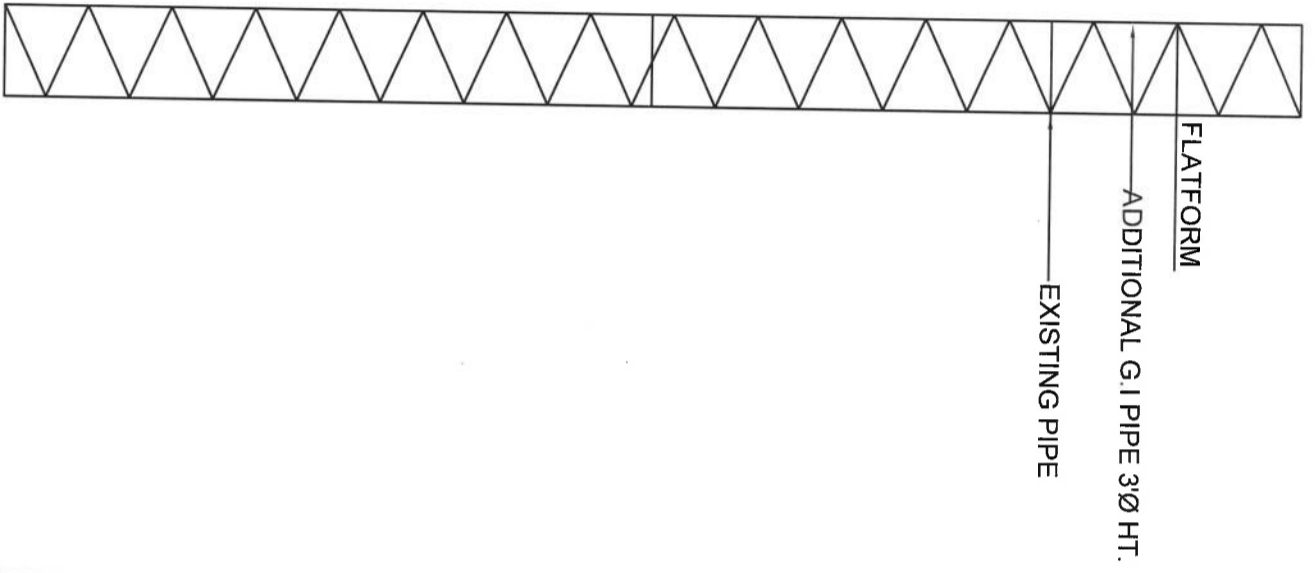

RIGHTSIDE VIEW

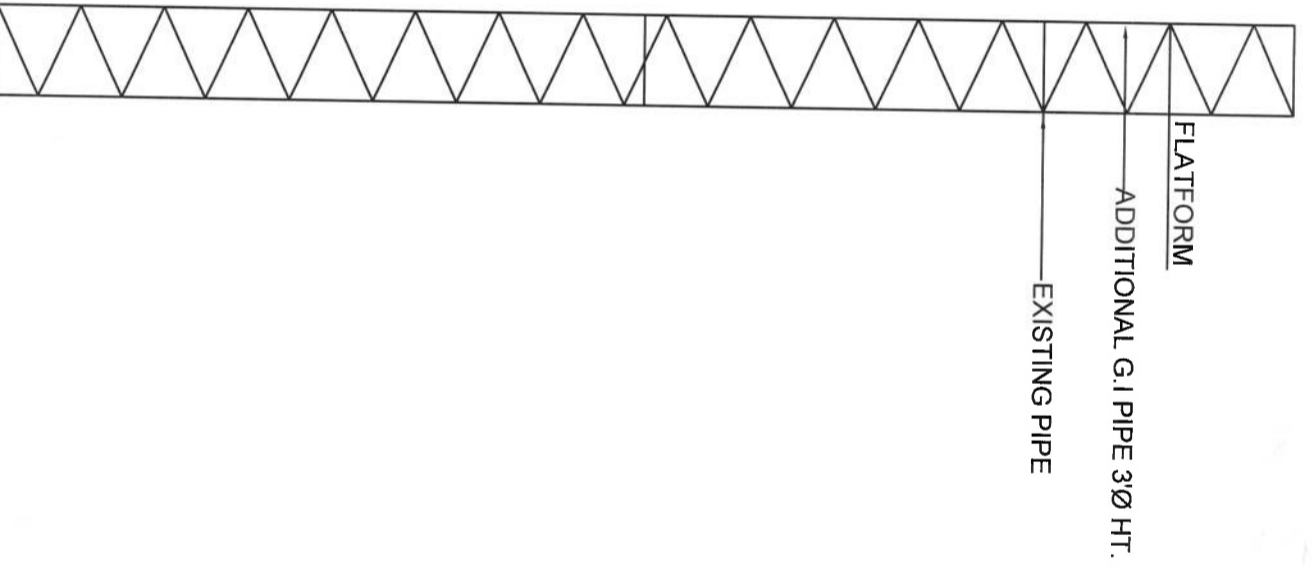

REARVIEW

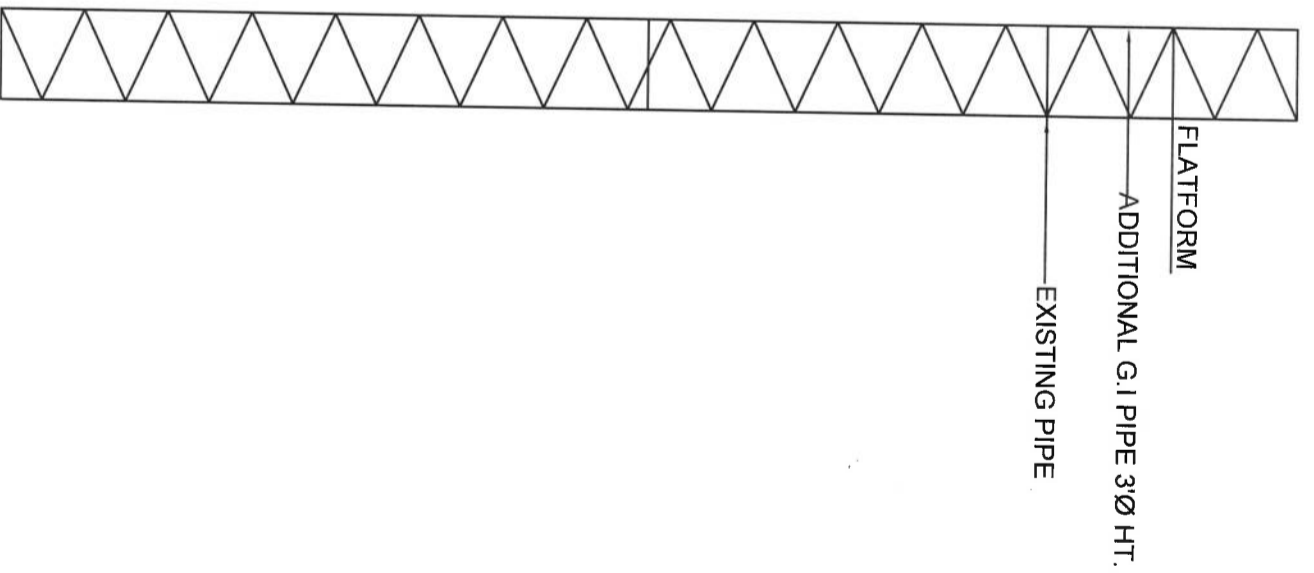

ISOMETRIC VIEW

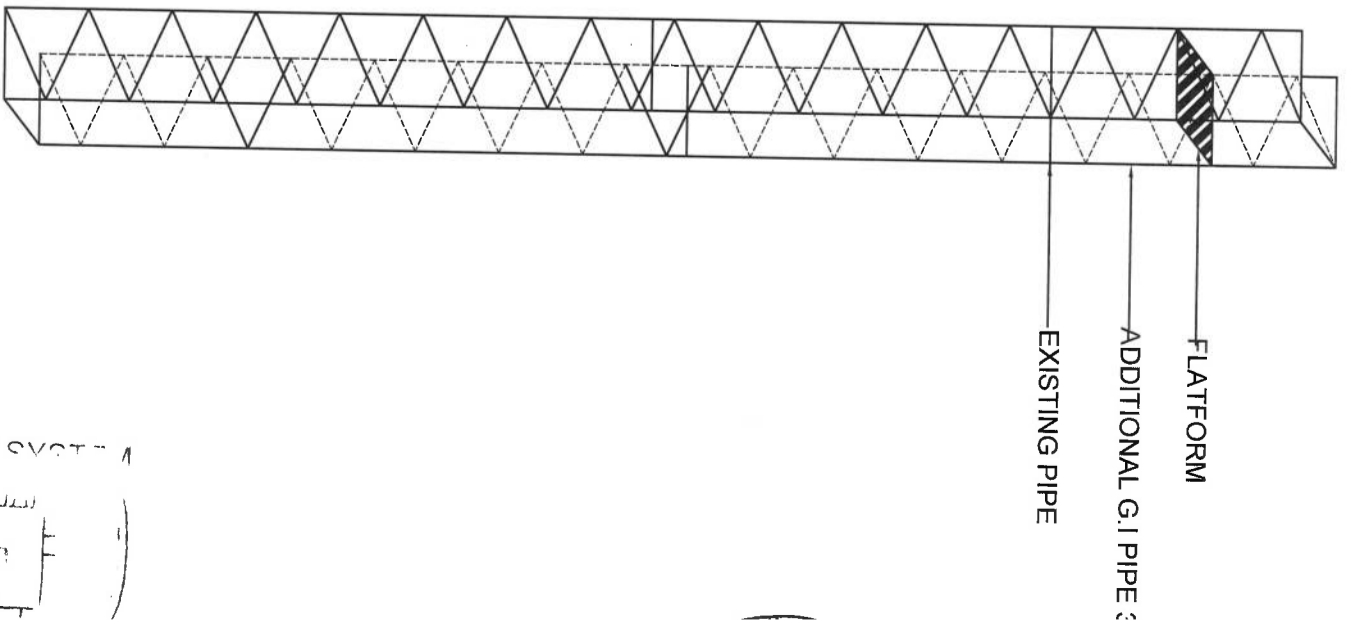

SOCIAL SECURITY SYSTEM
REF
 06 FEB 2008
 2:53 PM