

PROJECT: PREVENTIVE MAINTENANCE OF SEWERAGE TREATMENT PLANT AT FCA-5 PROPERTY (RE-ADVERTISEMENT)

QUERIES/CLARIFICATIONS RAISED DURING THE PRE-BID CONFERENCE:

	Query/Clarifications	TWG/BAC Reply
1	What is the original design of STP?	The design is Sequencing Batch Reactor plus Electro Contaminant Remover.
2	What is the standard CPM per day? Is it for the last 6 months?(water consumption of 180 to 250m ³ per day) So, the average would be 100cpm per day?	The capacity of the current STP is 400m ³ per day Yes. The water consumption for the last six (6) months would be 180 to 250m ³ per day. The average range would be 180 – 250m ³ per day.
3	May the bidder have a copy of the current as built plan?	We will issue a soft copy of the as built plan together with the Bid Bulletin.
4	Is it really necessary to have the PCO, mechanical pipefitter and electrician on site? Based on experience in the past five years of operations and maintenance of STP, only the operator is required to be on site although they are under direct supervision of the aforementioned personnel.	Yes. The PCO, mechanical pipefitter and electrician are required to be always on site to handle daily requirements and any emergencies. The aforementioned personnel is included in the computation of the ABC as stated in the bid documents. In case the PCO, mechanical pipefitter and electrician cannot be on site, that will be a deduction on the part of the service provider. The DTR of personnel is part of the attachment in the submission of billing.
5	Is the STP still operational until now? May the bidders have a copy of the last ROLA (Result of Laboratory Analysis)? A copy of the last ROLA can help in the determination if the existing design is compliant to the parameters.	Yes. The subject STP is still operational until now. No. The last ROLA will be issued to the winning bidder. If the concern is the compliance with the parameters, there are tests that are quarterly submitted to the LLDA for testing, and we always have a passing mark.
6	In the conduct of site inspection, does it require a letter of endorsement?	No. Kindly coordinate with BAC Secretariat thru email.

Note :

1. Discharge Point
2. Hidden Line - Un
3. (for Inlet & Oil C
- If In Doubt Pleas

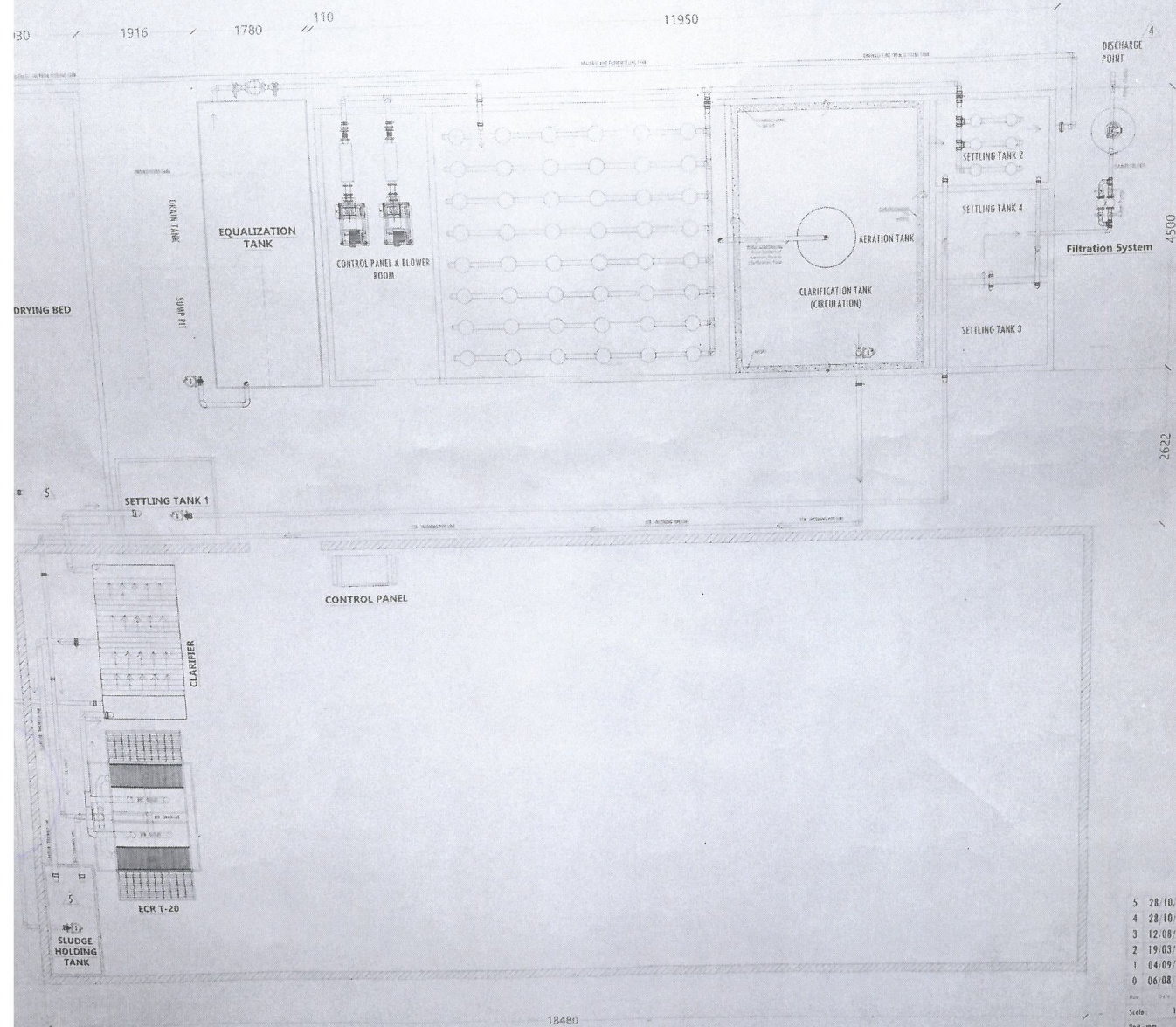

5	28/10/20	SB	JE
4	28/10/20	SB	
3	12/08/20	SB	
2	19/03/20	SB	
1	04/09/19	SB	
0	06/08/19	SB	
Rev	Date	Drawn by	Checked by
Scale:	1 : 1		
Unit: mm			
Material:			

A3

TRIDENT WATER
Client: SOCIAL SECURITY
Title: LAYOUT & EQUIPMENT
Treatment System
This drawing is the property of PPL
contains information of CONFIDENTIAL and
on unauthorized personnel or used in
File No: 2019008
Variant: S-101120
Draw No: TWS/PHP-SSS