

PROJECT: MODULAR FURNITURE – CORPORATE SERVICES SECTOR (6/F), ESPRESSO CAFÉ-LIBRARY, MAIN BUILDING STAGING AREA & TREASURY DIVISION, CASH DEPARTMENT, SECURITIES SETTLEMENT AND CUSTODY DEPARTMENT, LIQUIDITY MANAGEMENT BANK DEPOSITS DEPARTMENT

QUERIES/CLARIFICATIONS RAISED DURING THE PRE-BID CONFERENCE:

	Query/Clarifications	TWG/BAC Reply
1	For the gas lift mechanism, is there a required specific mechanism?	Yes, and that will be the German Gas Lift Mechanism as stated in the Technical Specification.
2	Do we need to attach a Manufacturers Certificate for the fabric?	Yes, bidders Manufacturers Certificate for the fabric should be attached as compliance with the Technical Specification.
3	Is it okay to submit the Bid Proposal online? We are based in Cagayan de Oro City.	No online submission but bidder may submit its bid at the Office of the Branch Head of the SSS Cagayan De Oro Branch.
4	We notice that for Lot 3, Technical Specifications and Bill of Quantities details are not the same.	The material to be used for Supervisor Workstation is HPL (High Pressure Laminate) finish.
5	For Lounge Barcelona, Dining Bar, Teller Chairs, Ottoman, Tone Dining, Stackable Chairs and Modular Bench, does it need to be the same design or is it okay to offer other design as long as it is the same materials?	Yes, it is okay to offer other design as long as it is compliant with the requirements as stated in the Technical Specifications, subject for approval of SSS.
6	Do we need to submit a mock sample of the chairs mentioned?	Yes, it is required to submit a mock sample for Lot 2, as stated in the Terms of Reference.

WRITTEN QUERIES:

	Query/Clarifications	TWG/BAC Reply
1	Under Lot 3 of item 4. Modular Partition (Executive Offices), what is the width dimension?	The width varies from 1.82 m to 3.3 meters, you may refer to the attached Furniture Layout for the dimension or see attached Annex A-1.
2	Under BOQ Lot 4 of Treasury Division letter A. Executive Workstation, where did the 1.0 Worktop 2000mm L x 750mm D x 740 mm H come from?	It is the size of the worktop.

3	Under BOQ Lot 4 of Cash Management Department letter A. Department Head Workstation, there is a discrepancy in the product name between Technical Specification and BOQ.	There is no discrepancy in the product name. For clarity, the dimension is 750mm (D) x 2000mm (L) x 740mm (H) as specified on the BOQ.
4	Under BOQ Lot 4 of Cash Management Department letter D. Staff Workstation - 1seater (Cashier), please confirm if the design is the same except for the dimension?	Letter D – Staff workstation for the cashier has the same design but different dimension and with side drawer. You may refer to the photo on the Technical Specification – Teller's booth – 1 seater (SW3) or on Annex A-1 item 2
5	Requesting clearer photos in all angle for the Guard Podium	Refer to Annex A-1 item 3.
6	Lot 2, item II, Tables and Contract Furniture—Regarding tabletop post-forming, is it possible for PVC flat edging, especially in round tabletops?	For the round dining table & round center coffee table, PVC flat edging is acceptable while items with angular corners should be beveled or rounded.

Other Clarifications

	Clarification
1	<p>The material to be used for Supervisor Workstation is HPL instead of fabric.</p> <p>This amends the technical specifications for the following lots:</p> <ul style="list-style-type: none"> - III - Item No. 2 - IV - Item No. 2 <p>See attached Annex A-2</p>

Annex A-1

1. Lot 3 – Staging Area
 - Item 4 - Modular Partition
 - Blow-up of Furniture Layout

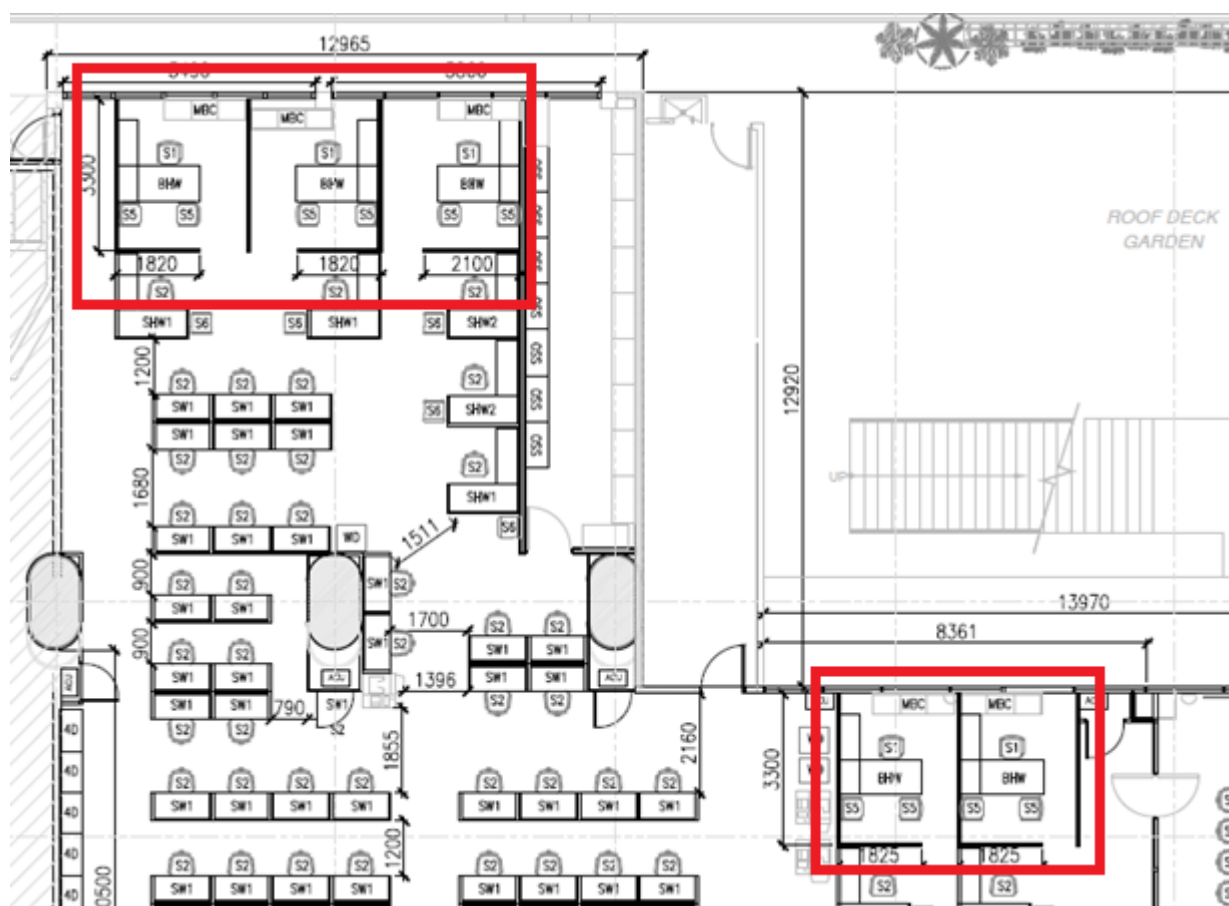

2. Cashier / Teller's Booth

4.	TELLER'S BOOTH- 1 SEATER (SW3)	
	DESIGN CONSTRUCTION	Modular workstation with 50mm thk modular panels in medium density fiber (MDF) board in HPL finish with 30mm thk MDF board tabletop in High Pressure Laminate finish
	Worktop:	1200m (W) x 600mm (D) x 30mm thk medium density fiber (MDF) board in HPL finish, with 2mm thk PVC edging and two (2) plastic grommet with rotating cover
	Modular Panel High Partition (front):	1100mm (H) x 1200 (W) x 50mm thk modular panel in medium density fiber (MDF) board in HPL finish with adjustable gliders
	Modular Panel High Partition (sides):	1100mm (H) x 1200 (W) x 50mm thk modular panel panel in medium density fiber (MDF) board in HPL finish with adjustable gliders
	Frame, Trim, Capping, and Corner Posts:	Extruded aluminum in powder-coated finish. <i>Submit sample</i>
	Skirting/ Base	100mm (H) powder-coated aluminum panel with raceway for cables
	ACCESSORIES	
	Foot Glide	Adjustable heavy-duty foot glides, 2 pieces each panel
	Cash drawer	650mm (W) x 600mm (D) x 125mm (H) using 25 mm thk MDF board in HPL finish and provided with money tray, drawer lock, recessed handle & full extension drawer slides.
	COLOR/ FINISHES	<i>Specific Colors/ Finishes subject for approval</i>
	High Pressure Laminate Finish	Desk tabletop: Wood grain Finish Modular Panels: White (Top); Gray (Bottom) Trims: Light Gray / Raceway: Dark Gray

Item	Specification
	

3. Guard's Station

